

PRODUCT SHEET

Freestanding Indoor lockable Showcase



Freestanding Indoor lockable Showcase

• Dry wipe side hinged Showcase • special designed aluminium pole 1800mm high • 4 x A4 with magnetic back wall • steel base with rubber feet

Standgestell für Schaukasten S

• speziell entwickeltes Aluminiumprofil, 1800mm hoch • 4 x A4 mit magnetischer Rückwand • Stahlfuß mit Gummifüßen

www.whitelightdisplay.co.uk

PRODUCT SHEET

Freestanding Indoor lockable Showcase

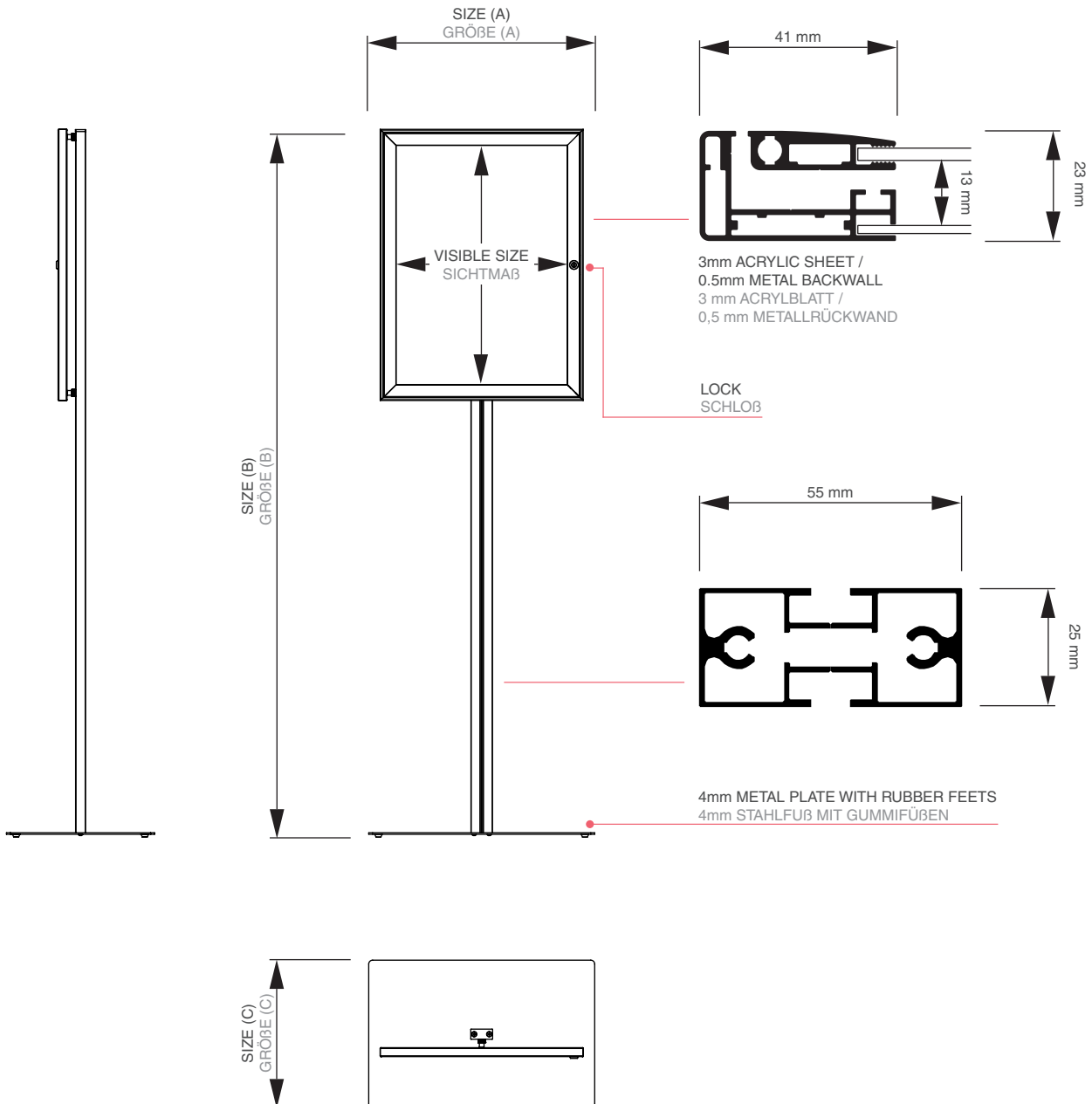

PRODUCT SHEET

Freestanding Indoor lockable Showcase

Article code	EAN / GTIN	Capacity	Visible size	Size (A x B x C)	Net weight
Artikelcode	EAN / GTIN	Kapazität	Sichtmaß	Größe (A x B x C)	Netto Gewicht
SCSPOLE4xA4	8596052028199	4x A4	440 x 615 mm	580 x 1817 x 380 mm	12,60 kg

Article code	Packing size	Packing weight	Pcs / pallet	Weight of pallet	Volumetric weight	Belt size	Shipping
Artikelcode	Verpackungsgröße	Versandgewicht	Stck / Palette	Paletten-gewicht	Volumen-gewicht	Gurtmaß	Versandart
SCSPOLE4xA4	1840 x 790 x 80 mm	17,13 kg	15	277 kg	23,26 kg	3580 mm	TOF